

FOES Racing /Curnutt Air Shock Basic setting manual

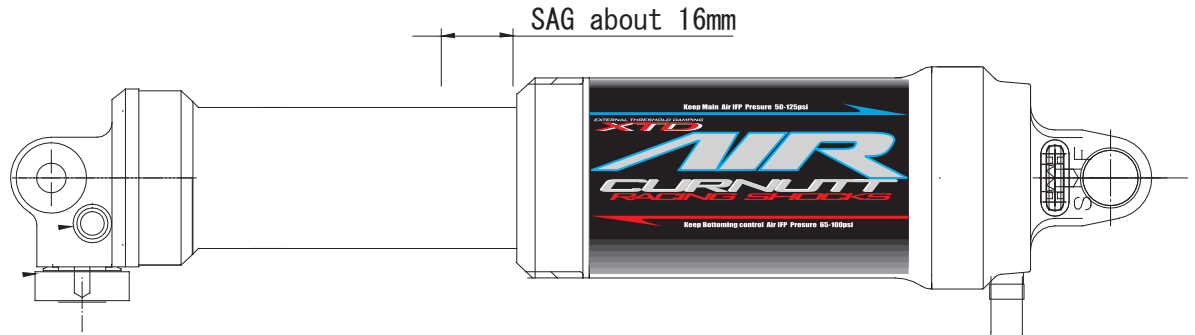

1: SAG adjustment Set SAG at 16mm shock stroke. adjust at Main Air Chamber with proper air pressure

Bottoming control
Factory setting 65 PSI
Dial at 2 turns out
(Factory setting)



Average air pressure in Resivere
will be in the range from
50PSI to 125PSI
but you need to check SAG.
Should be about 16mm

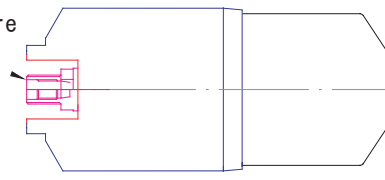

← Main Air Chamber needs to be Full open when setting SAG

2: Hydraulic Bottoming Control adjustment

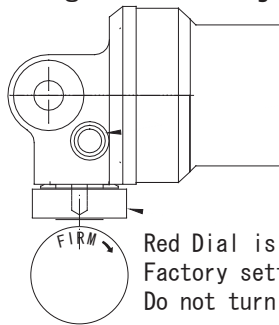

Bottoming control Air valve factory setting is 65 PSI
Do not go lower than 65PSI
and no higher than 100 PSI
this air pressure is for bottoming control

Red Dial is to fine tune bottoming control.
Factory setting is 2 turns out from max firm.
Do not turn red dial beyond 4 turns from max firm.

3: Air Spring Rate Curve adjustment (Air reservoir adjustment effects End of stroke curve about 100lb)

Lower Air pressure to about 30PSI
when adjustment spring rate curve

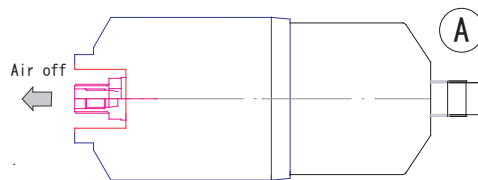

This is Done by turning Blue Cap on Reservoir clockwise →



After reservoir has been adjusted put correct
Air pressure in reservoir to get proper SAG

